

VIBRATION MANAGEMENT CORPORATION

5930 THOMAS ROAD , HOUSTON , TEXAS 77041 , U.S.A

INTERNET ADDRESS: www.vimco.biz

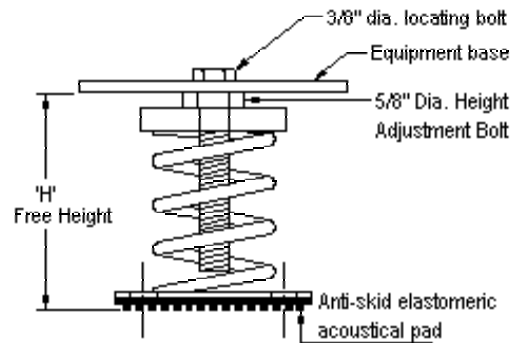
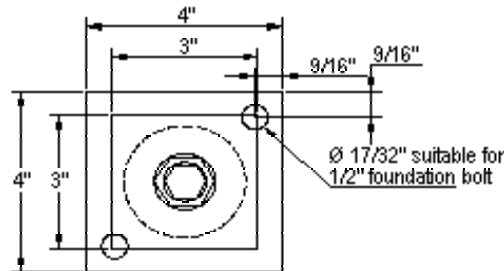
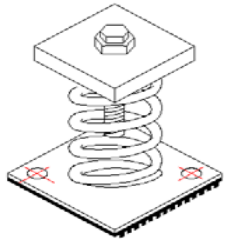

N.T.S.

ISOLATOR MODEL	RATED LOAD (lbs)	SOLID LOAD (lbs)	H (inches)
OSM-1-081	32	48	5 1/4
OSM-1-082	50	76	
OSM-1-083	89	134	
OSM-1-084	158	237	
OSM-1-085	280	420	
OSM-1-086	360	540	
OSM-1-087	485	728	
OSM-1-201	60	90	7 1/4
OSM-1-202	100	150	
OSM-1-203	150	225	
OSM-1-204	250	375	
OSM-1-205	400	600	
OSM-1-206	700	1050	
OSM-1-207	926	1390	
OSM-1-201-219	593	890	
OSM-1-202-219	633	950	
OSM-1-203-219	683	1025	
OSM-1-204-219	783	1175	
OSM-1-205-219	933	1400	
OSM-1-206-219	1233	1850	
OSM-1-207-219	1460	2190	

NOTES

1. Isolators have a min. operating Kx/Ky ratio of 1.0
2. Springs have 50% additional travel to solid beyond rated load.
3. Isolators should be selected in the range of -30% to +25% of rated load.
4. Consult spring chart for isolator performance data.

FEATURES

- * Welded construction
- * Anti-skid elastomeric acoustical pad
- * Built-in leveling device
- * Mounting holes furnished as standard
- * Galvanized finish
- * High deflection, low natural frequency
- * Spring elements color-coded for easy field verification

Notes / Remarks :

Project :
Client :
Consultant :
Representative :

Title :

OSM-1
Free-standing Spring Mount
Welded Construction
(2" deflection)

Drawing no. **S-2050.11**
Rev. **3**