

VIBRATION MANAGEMENT CORPORATION

5930 THOMAS ROAD , HOUSTON , TEXAS 77041 , U.S.A

INTERNET ADDRESS: www.vimco.biz

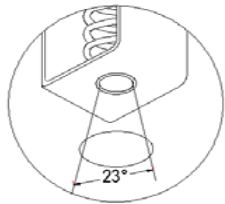
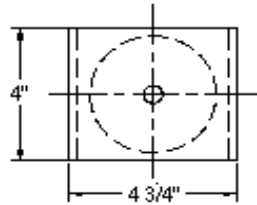
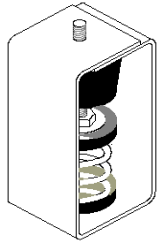

Not applicable with booster springs

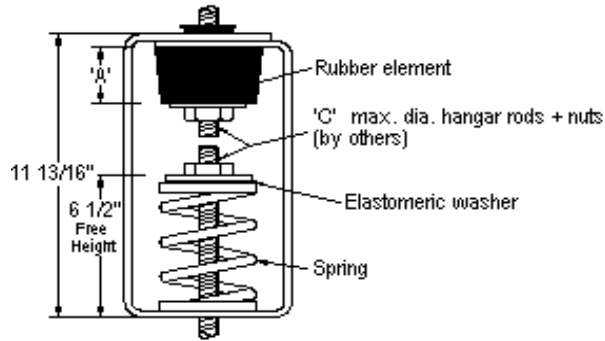

N.T.S.

ISOLATOR MODEL	RATED LOAD (lbs)	SOLID LOAD (lbs)	'A' (inches)	'C' (inches)
HNSE-A4-201	60	90	1 1/4	1/2
HNSE-B1-202	100	150	1 3/4	5/8
HNSE-B2-203	150	225	1 3/4	5/8
HNSE-B3-204	250	375	1 3/4	5/8
HNSE-C3-205	400	600	3 1/8	5/8
HNSE-C4-206	700	1050	3 1/8	5/8
HNSE-C4-207	926	1390	3 1/8	5/8
HNSE-C3-201-219	593	890	3 1/8	5/8
HNSE-C4-202-219	633	950	3 1/8	5/8
HNSE-C4-203-219	683	1025	3 1/8	5/8
HNSE-C4-204-219	783	1175	3 1/8	5/8
HNSE-C4-205-219	933	1400	3 1/8	5/8
HNSE-D2-206-219	1233	1850	3 1/8	3/4
HNSE-D2-207-219	1460	2190	3 1/8	3/4

FEATURES

- * Load distribution steel washer
- * Embedded steel plates in rubber element for uniform loading.
- * Oil + water resistant rubber element
- * High deflection, low natural frequency
- * Spring / Rubber elements color-coded for easy field verification
(*Rubber element color coding can be by 'dot' or 'complete element'*)
- * Rubber element incorporates projected collar to prevent metal to metal contact between rod and bracket.

NOTES

1. Springs have 50% additional travel to solid beyond rated load.
2. Isolators should be selected in the range of -30% to +25% of rated load.
3. Consult spring chart for isolator performance data.
4. Contact factory for optional drilling to accept larger hanger rod sizes.

Notes / Remarks :

Project :
Client :
Consultant :
Representative :

Title :

HNSE
Neo-Spring™ Hanger
(2.5" deflection)

Drawing no.
S-2400.13

Rev. 0