

VIBRATION MANAGEMENT CORPORATION

5930 THOMAS ROAD , HOUSTON , TEXAS 77041 , U.S.A

INTERNET ADDRESS: www.vimco.biz



MODEL	ROD SIZE A (inches)	PART DIMENSIONS (inches)				MAX. LOAD	
		B	C	D	E	TOP (lbs)	BOTTOM (lbs)
JBC-03-x	3/8	1 1/2	1 7/16	3/4	1 3/16	500	250
JBC-05-x	1/2	1 5/8	1 1/2	3/4	1 1/4	950	760
JBC-06-x	5/8	1 3/4	1 1/2	3/4	1 3/32	800	620
JBC-07-x	3/4	2 1/4	1 3/4	1 1/16	1 5/16	800	620
JBC-08-x	7/8	2 1/4	1 3/4	1 1/16	1 5/16	800	620

NOTES

1. Choose appropriate model for required finish:
P-Plain. G-Electro Galvanized.
2. Table lists maximum recommended loading for top and bottom attachments.
(Figure on right shows top attachment)

APPLICATION

- * For attachment of support hangar rods to *top or bottom* of structural materials: beams channels, angles etc. Suitable for structural materials up to 3/4" thick.

SPECIFICATIONS

- * Complies with Federal Specification A-A-1192A (Type 19 & 23)
- * Complies with ANSI/MSS SP-58-2009 (Type 19 & 23)

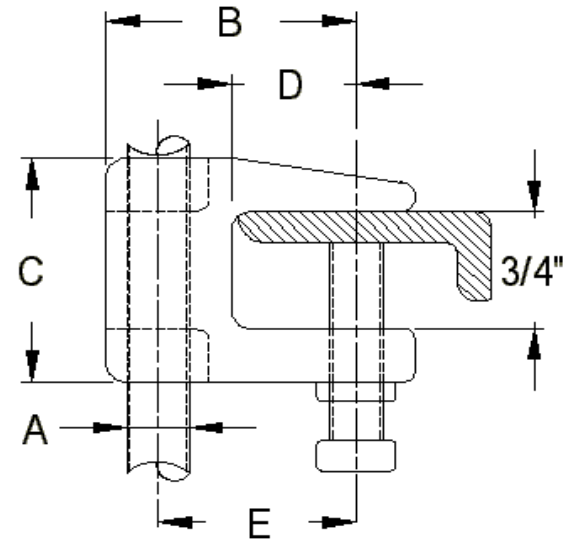

MATERIALS

Item	Description
Clamp	Cast Iron
Bolt + nut	Low carbon steel

FEATURES

- * Reversible design allows attachment to *top or bottom* of structural materials.
- * Provides for hangar rod offset from edge of beam/angle.

<u>Notes / Remarks :</u>	<u>Project</u> :	JBC Junior Beam Clamp	<u>Drawing no.</u>
	<u>Client</u> :		S-2739.21 Rev. 2
	<u>Consultant</u> :		
	<u>Representative</u> :		